

 Skullcandy®

PLYAR



## WELCOME TO SKULLCANDY GAMING



Download the Skull-HQ PC and Mobile App at [skullcandy.com/skull-hq](https://skullcandy.com/skull-hq) to unlock the full potential of your PLYR headset.



Scan for additional user guides and resources.

Warranty information at: [skullcandy.com/warranty](https://skullcandy.com/warranty) - Including platform specifics, Tile.

## DEVICE LAYOUT

### WELCOME TO SKULLCANDY GAMBING

1. USB-C-USB-A-Connection Cable/ Charging Cable
2. 3.5mm Aux Cable
3. Adjustable Headband
4. Play/ Pause/ Answer Call (x1 Press), Track Forward (x2 Press) – Top Left Earcap Button
5. Mute Button (x1 Press), Sidetone On/ Off (Long Press) – Bottom Left Earcap Button
6. Removable Clear Voice Smart Boom Mic
7. Built-in mic for on-the-go when boom mic is removed
8. USB-C and 3.5mm Aux Ports
9. Power Slider – Power On/ Off/ Enter Bluetooth Mode
10. Volume (Scroll), Cycle EQ Modes (x1 Press)
11. PLYR Wireless Transmitter with Ultra-Low Latency (SOLD SEPARATELY)

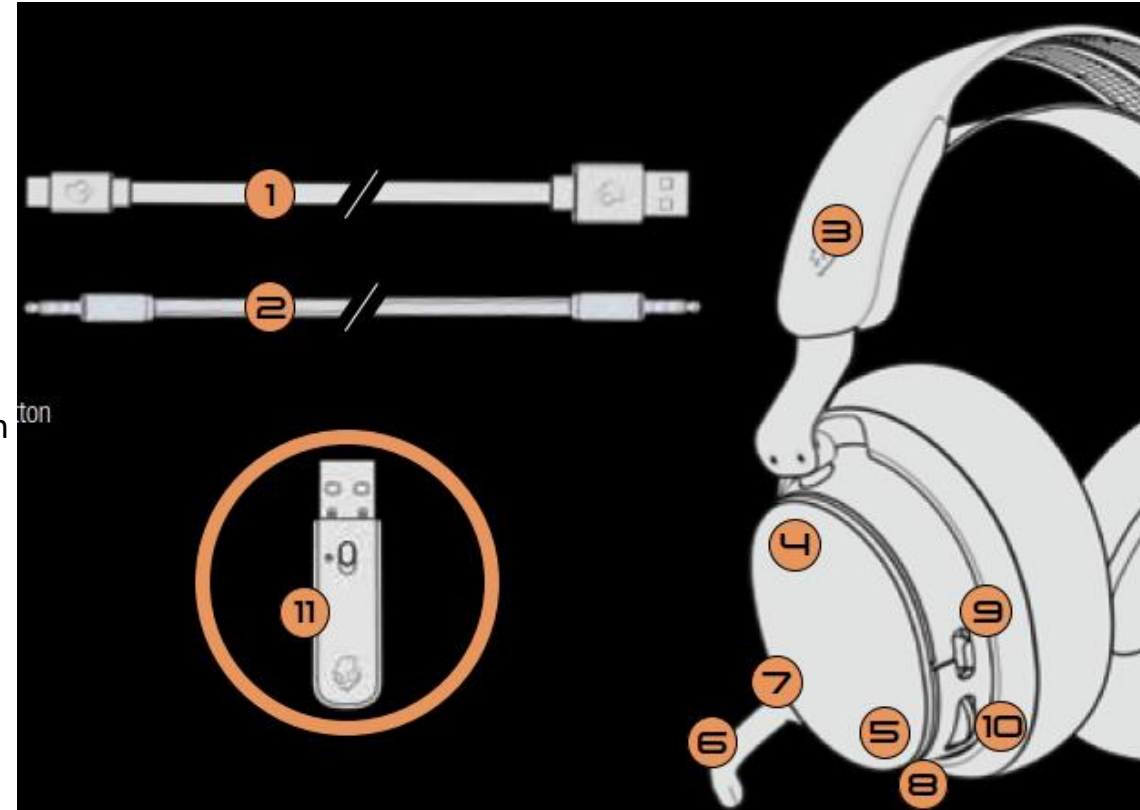

## USING YOUR PLYR

### GETTING STARTED

#### POWER ON

Move Power Slider to middle position

#### POWER OFF

Move Power Slider to bottom position

#### BLUETOOTH PAIRING MODE

For Nintendo Switch, PC and mobile wireless connection press and hold the power slider in the top position for 1 second to pair to your device

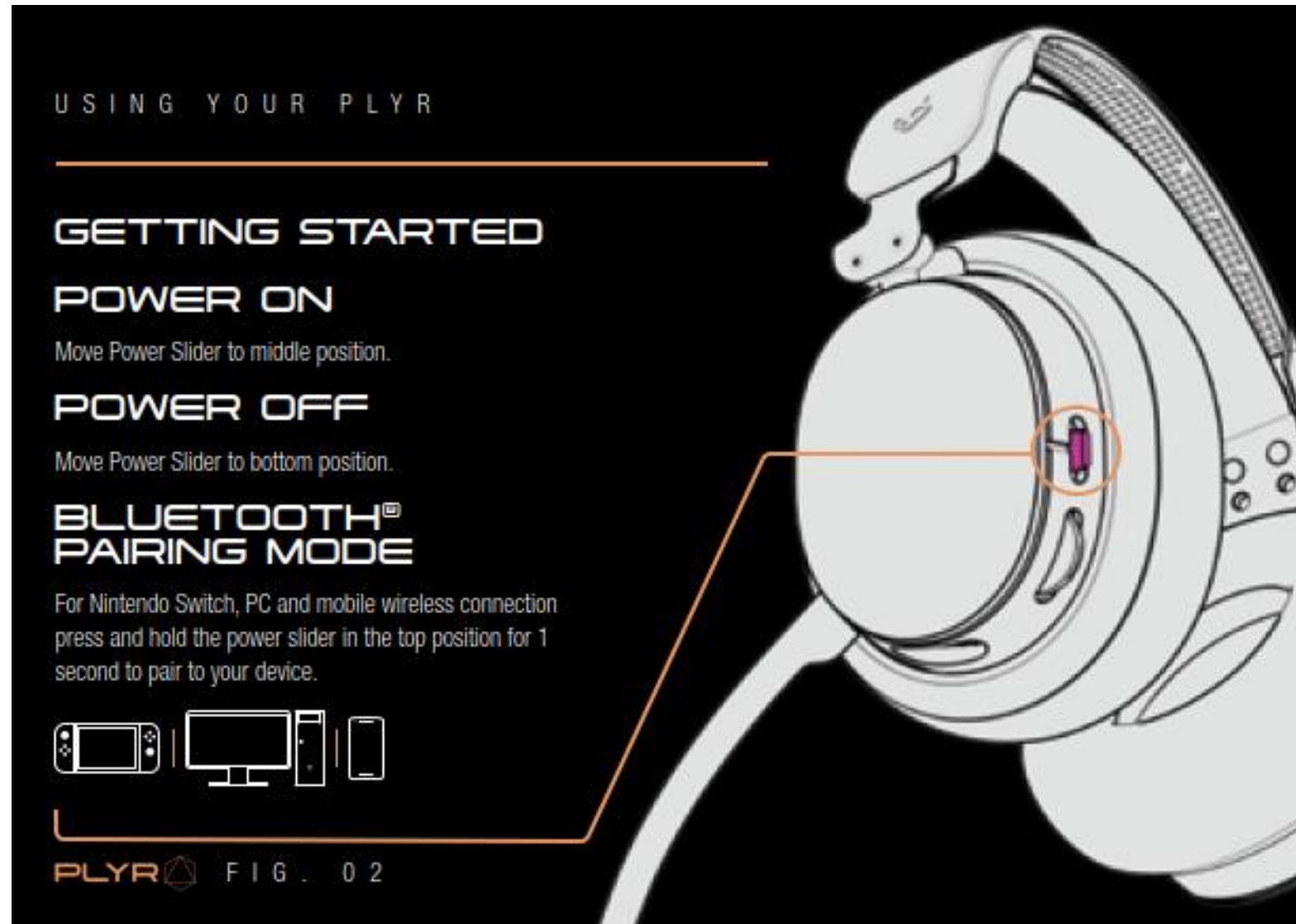

## USING YOUR PLYR

### **INCREASE VOLUME**

Scroll wheel up

### **DECREASE VOLUME**

Scroll wheel down

### **MASTER VOLUME**

Adjusting volume on the headset will affect both game volume and game chat volume equally. Game and Chat levels can be adjusted in the Skull-HQ Gaming App

## USING YOUR PLYR

### **INCREASE VOLUME**

Scroll wheel up.

### **DECREASE VOLUME**

Scroll wheel down.

### **MASTER VOLUME**

Adjusting volume on the headset will affect both game volume and game chat volume equally. Game and Chat levels can be adjusted in the the Skull-HQ™ Gaming App.

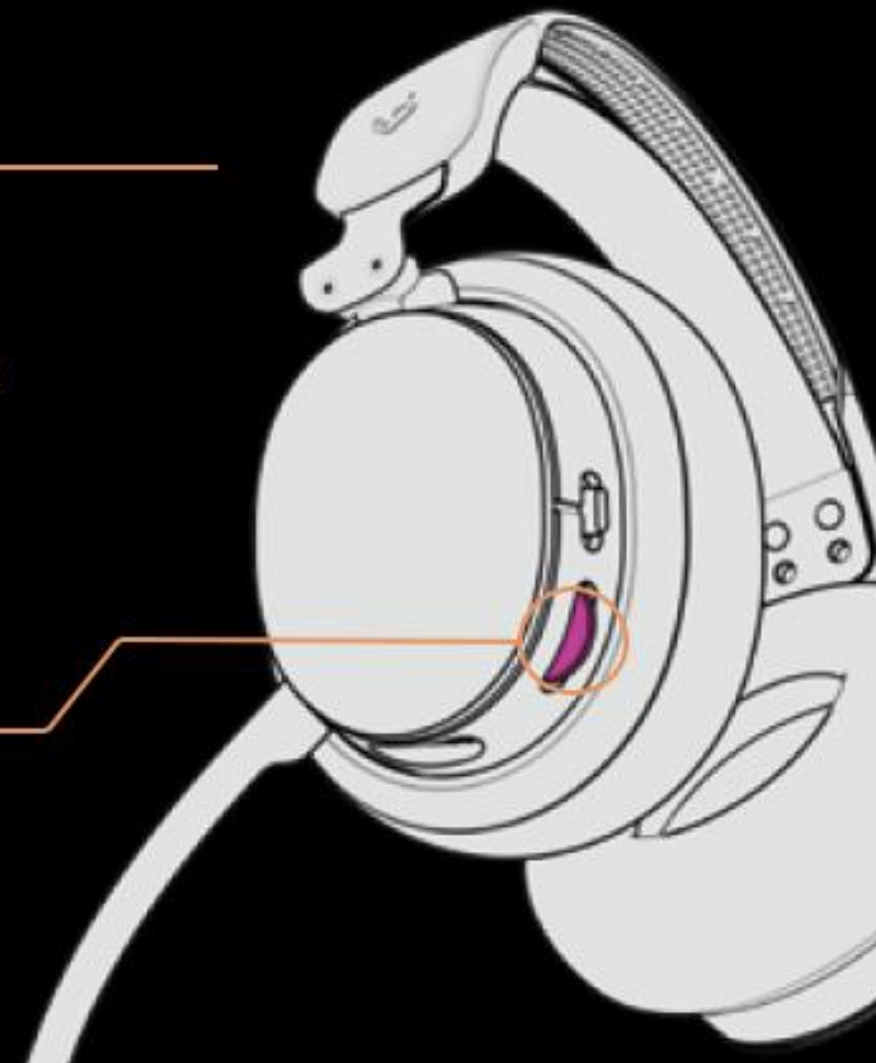

## USING YOUR PLYR

### **PLAY/ PAUSE**

Press top left earcap once

### **TRACK FORWARD**

Press top left earcap twice

### CALL CONTROLS:

#### **ANSWER CALL**

Press top left earcap once

#### **REJECT/ END CALL**

Press top left earcap twice

## USING YOUR PLYR

---

### **PLAY/PAUSE**

Press top left earcap once.

### **TRACK FORWARD**

Press top left earcap twice.

### **CALL CONTROLS:**

#### **ANSWER CALL**

Press top left earcap once.

#### **REJECT/END CALL**

Press top left earcap twice.

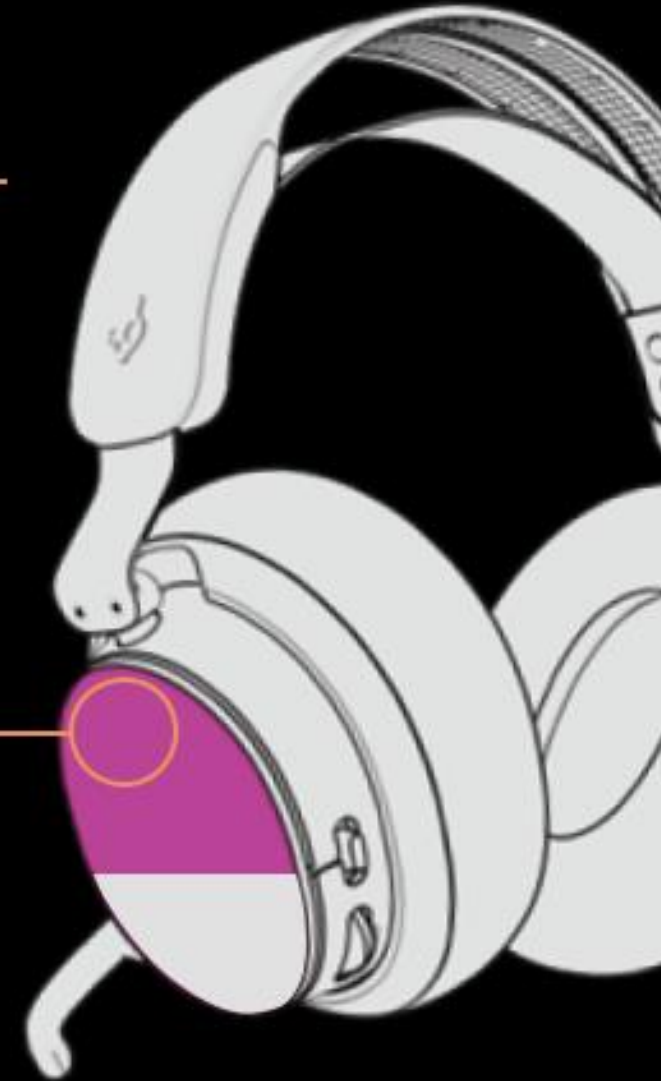

## USING YOUR PLYR

### **MUTE ON/ OFF**

Press bottom left earcap once

### **SIDETONE ON/ OFF**

Press and hold bottom left earcap for 2 seconds

## USING YOUR PLYR

### **MUTE ON/OFF**

Press bottom left earcap once.

### **SIDETONE ON/OFF**

Press and hold bottom left earcap for 2 seconds.

PLYR  FIG. 05



## USING YOUR PLYR

### **MUTE – LED ON**

Press bottom of left ear cap once. Mic is muted when LED is on.

### **MUTE – LED OFF**

Press bottom of left ear cap once. Mic is unmuted when LED is off.

## USING YOUR PLYR

---

### **MUTE - LED ON**

Press bottom of left ear cap once. Mic is muted when LED is on.



### **UNMUTE - LED OFF**

Press bottom of left ear cap once. Mic is unmuted when LED is off.



## USING YOUR PLYR

### **CYCLE THROUGH EQ MODES**

Press once to change EQ Mode

1. Default Gaming EQ: Skullcandy Supreme Sound
2. FPS Mode
3. RPG Mode
4. Music Mode
5. Custom EQ Mode – (Use the App for Custom Eqs)

For access to even more gaming and lifestyle EQ modes, download the Skull-HQ App

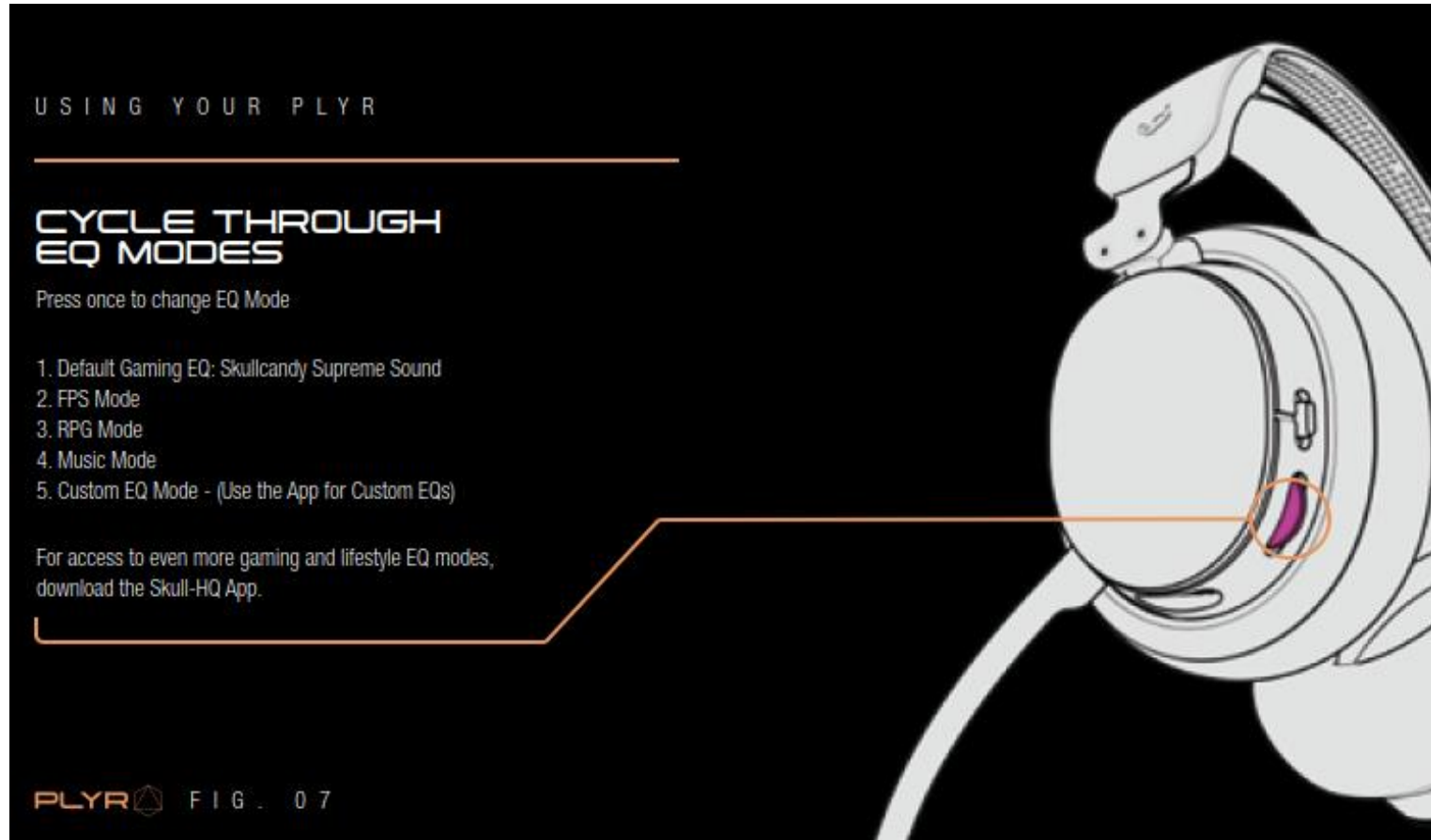

### CONNECTING TO PC OR CONSOLE

For an ultra low latency wireless connection use the wireless transmitter **SOLD SEPARATELY**

### USB C CABLE

For PC use, connect the USB-C cable to the headset and then connect the USB-A side into your PC

### AUX CABLE

For console use, connect the aux cable to the headset and then to your console's controller

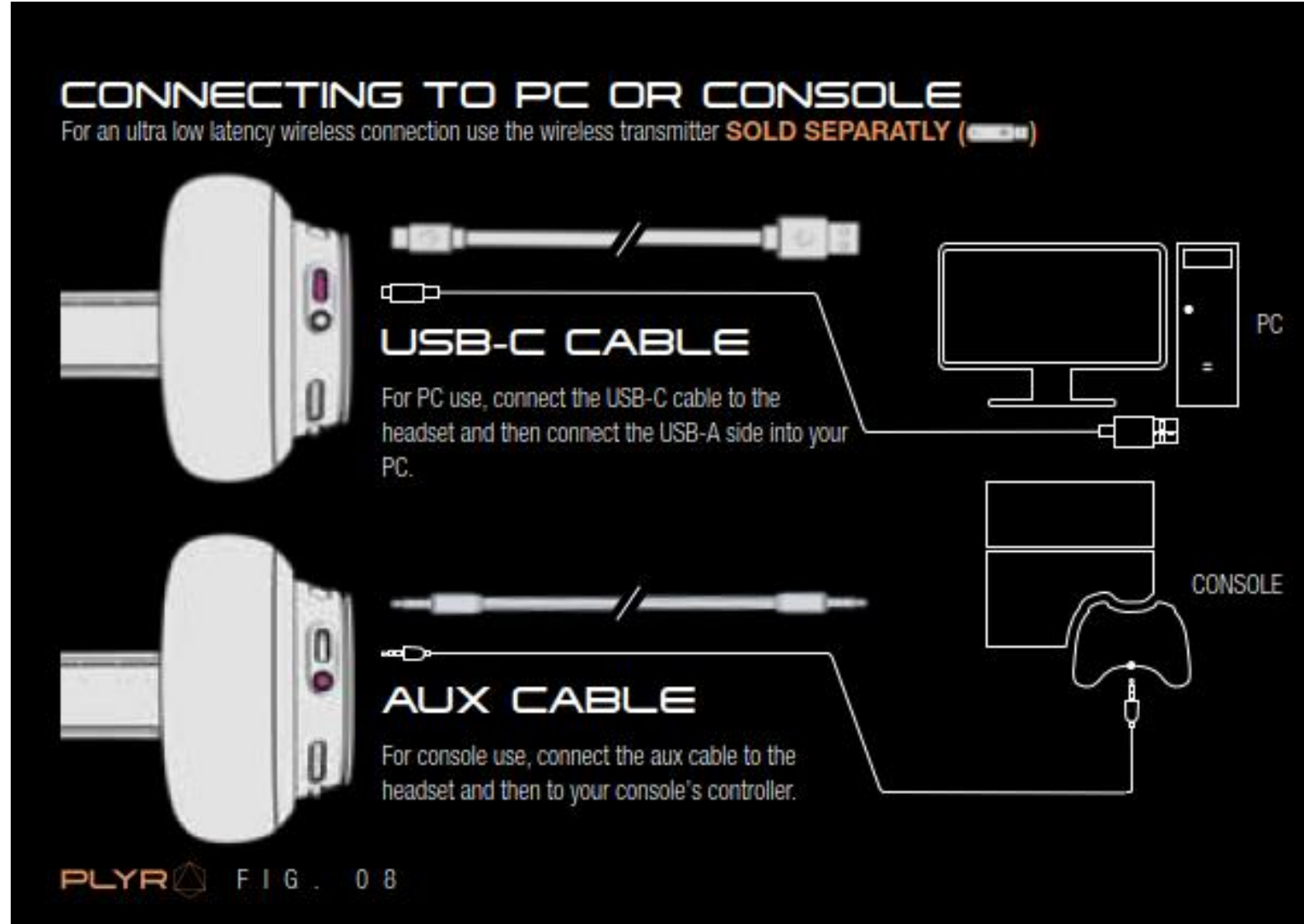

COMPATIBLE SETUP

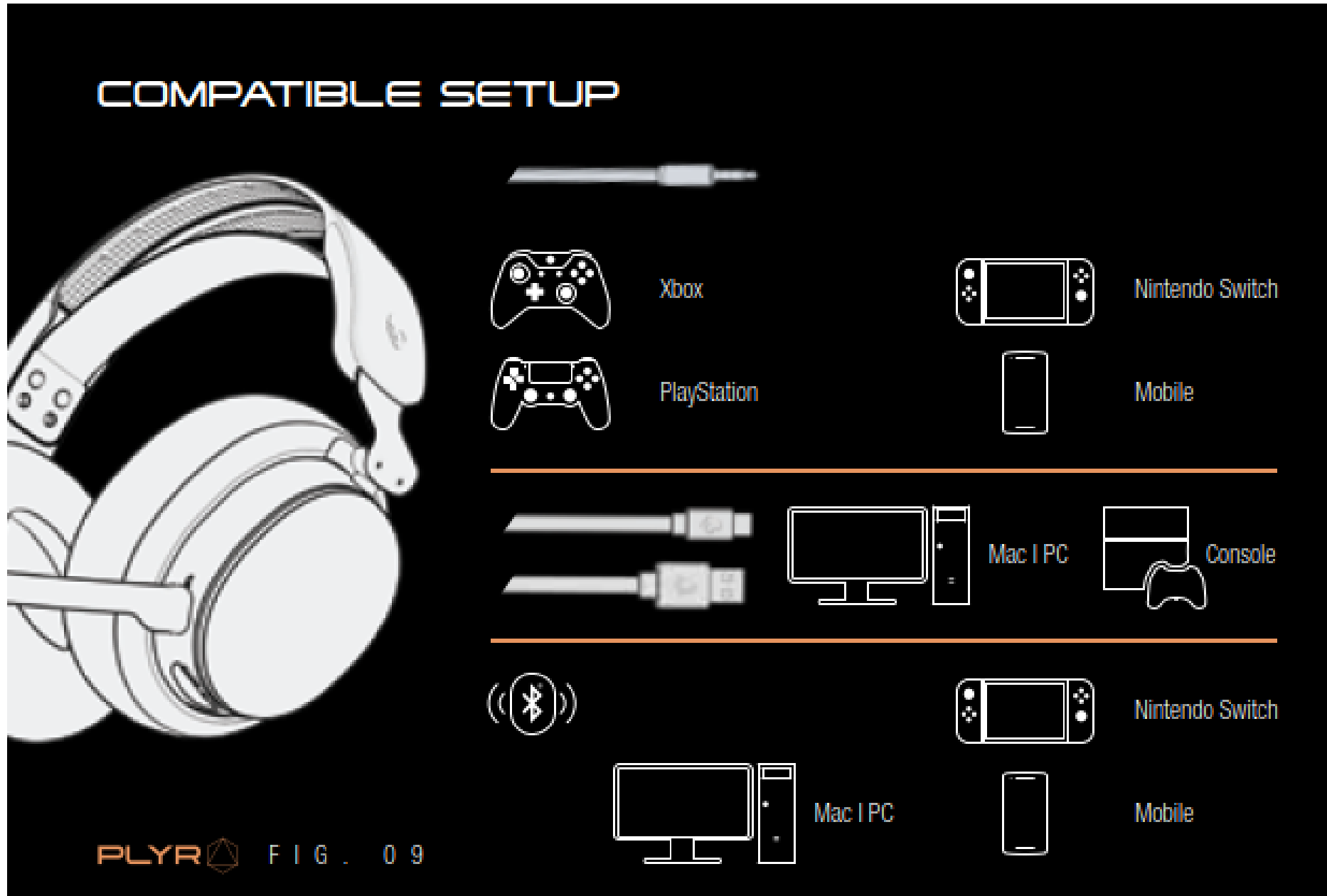

## USING YOUR PLYR + SKULL –HQ APP

### **SKULL – HQ PC GAMING APP**

Download the Skull – HQ PC App at [skullcandy.com/skull-hq](https://skullcandy.com/skull-hq) to unlock the full potential of your PLYR headset

### **APP FEATURES**

- Optimize audio to your unique hearing with Enhanced Sound Perception (E.S.P.)
- Charge EQ setting and create up to 3 custom Eqs
- Adjust volume
- Adjust microphone input volume
- Adjust sidetone
- Game and chat levels

### **SKULLCANDY APP (MOBILE DEVICE)**

For a similar experience on mobile, PLYR also connects to the Skullcandy App.

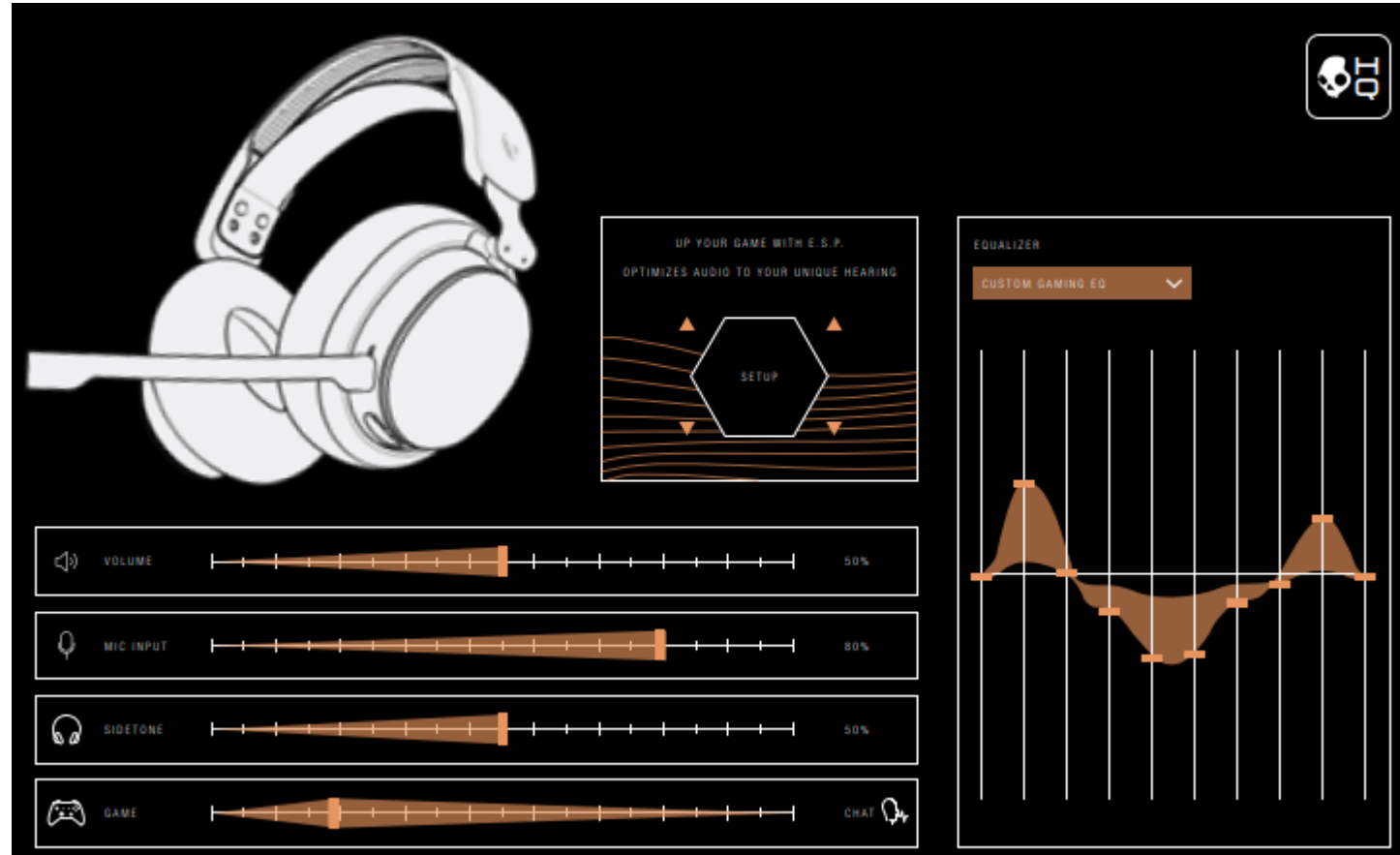

PLYR  FIG. 10

Scan to  
download.

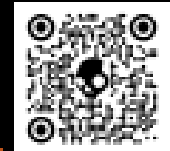

## USING YOUR PLYR

### **CHANGE YOUR PLYR**

When the battery is low the headset LED will flash red.

To charge your device connect the USB-C cable to your headset then connect USB-A to PC or Console to continue playing while your device charges or plug into traditional charge port.

Your PLYR has up to 24 hours of battery life, with rapid charge.  
10 minutes of charge = 2 hours of playtime.

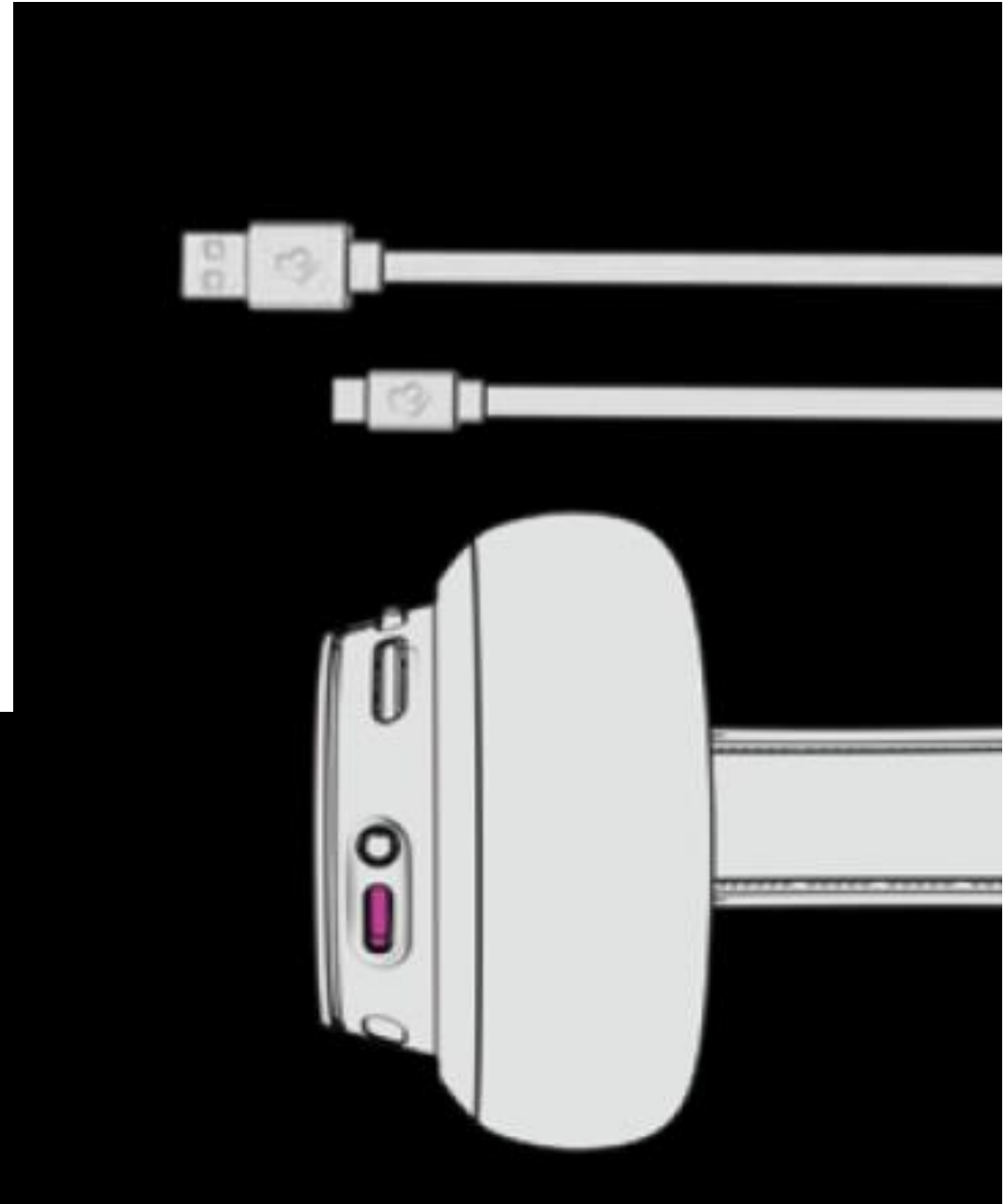
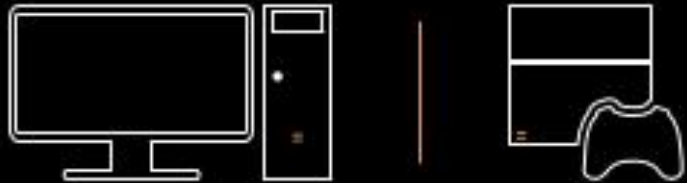

## USING YOUR PLYR

### TLE FINDING TECHNOLOGY

To connect PLYR headset to Tile, download the TILE TM App. Once you have downloaded the Tile app follow the on-screen instructions to connect PLYR so it is trackable.

## USING YOUR PLYR

---

### TILE FINDING TECHNOLOGY

To connect PLYR headset to Tile, download the Tile™ App. Once you've downloaded the Tile app follow the on-screen instructions to connect PLYR so it's trackable.



QUESTIONS: visit  
[www.skullcandy.com](http://www.skullcandy.com)

Americas  
Skullcandy, Inc.  
6301 N Landmark Dr.  
Park City, UT 84098 U.S.A.  
[Skullcandy.com](http://Skullcandy.com)

Canada  
Skullcandy Canada ULC  
329 Railway St. Unit 205  
Vancouver, BC. V6A 1A4 Canada  
[Skullcandy.ca](http://Skullcandy.ca)

EN Made in Vietnam.  
FR Fabriqué en Vietnam.  
ES Hecho en Vietnam.  
ZH 越南制造。

Europe  
Skullcandy Europe BV  
Postbus 425  
5500AK Veldhoven Nederland  
[Skullcandy.eu](http://Skullcandy.eu)

Skullcandy UK LTD  
Andrews House  
College Road  
Guildford  
GU1 4QB  
[Skullcandy.co.uk](http://Skullcandy.co.uk)

México  
Skullcandy Mexico S de RL de CV  
Aristoteles 218  
Polanco IV Seccion, Miguel Hidalgo  
11550, México City, México  
[Skullcandy.mx](http://Skullcandy.mx)



PLYR  
MODEL: 38PPY  
FCC ID: Y22-38PPY  
IC: 10488A-38PPY

MP